



COOLOOLA SHIRE COUNCIL

AGENDA

of the

**WORKS & SERVICES
COMMITTEE MEETING**

CHAIRMAN: Cr Larry Friske

**Held in the Boardroom
Old Bank Building,
Cnr Nash & Channon Streets
Gympie Qld 4570**

on Tuesday 5 February 2008, following the General Meeting.

**for Adoption at the
General Meeting
to be held on 12 February 2008**



Cooloolo Shire Council

WORKS & SERVICES AGENDA

*Cr L.J. Friske (Chairman),
Crs. M.J. Venardos OAM, CR Chapman OAM, N.R. Ellis, W.J. McIntyre, W.W. Sachs, R. Owen, S.S. Jocusen.*

Also as observers are Crs D.R. Neilson, I.T. Petersen, J. Watt, F.G. Nissen AM and M. Prior.

APPOINTMENTS etc.

CONTENTS:

LEAVE OF ABSENCE / APOLOGIES	5
APPOINTMENT OF PROXY/DELEGATE	5
CONFIRMATION OF PREVIOUS MEETING	5
SECTION 1: DIRECTOR OF ENGINEERING.....	5
1/1 BORUMBA DAM WATER STORAGE.....	5
1/2 CAPITAL WORKS, MAINTENANCE, DESIGN AND DMR CONTRACT WORKS - AMAMOR	6
1/3 REVENUE COLLECTED FROM SPEED CAMERA FINES	7
1/4 SPEED RESTRICTION BRUCE HIGHWAY, CHATSWORTH – MINUTE G71/01/08 REFERS.....	8
1/5 REDUCTION IN MAINTENANCE BOND – STAGE 2 – D BRIGHTON DEVELOPMENT – OLD MARYBOROUGH ROAD, GYMPIE – MINUTE G62/01/08 REFERS	9
1/6 WHITE BRIDGE, TIN CAN BAY ROAD.....	10
1/7 ROAD MAINTENANCE – LUCKY ROAD, EAST DEEP CREEK.....	11
1/8 BRUCE HIGHWAY, MONKLAND.....	12
1/9 MOY POCKET ROAD.....	13
SECTION 2: DIRECTOR OF ENGINEERING - GENERAL BUSINESS.....	15
SECTION 3: DESIGN DEPARTMENT.....	15
3/1 ROAD NAME – UNFORMED ROAD RESERVE, WIDGEE CROSSING SOUTH.....	15
3/2 PROPOSED ROAD NAME OFF VAN DOREN ROAD – OPUS QANTEC MCWILLIAM.....	17
3/3 TRAFFIC ADVISORY COMMITTEE MEETING	17
3/4 SPEED LIMIT IN WATT STREET, GYMPIE - MINUTE G32/12/07 REFERS	18
3/5 STORMWATER & SILT PROBLEMS - MINUTE G74/12/07 REFERS	18
3/6 PROPOSED ILLUMINATED STREET NAME SIGN – CORNER OF EXCELSIOR ROAD & HYNE STREET, GYMPIE	19
3/7 FUTURE ROADS & DRAINAGE CAPITAL WORKS BUDGETS	21
SECTION 4: DESIGN DEPARTMENT - GENERAL BUSINESS.....	22

SECTION 5: WORKS DEPARTMENT (ROADS/ DRAINAGE/PLANT)	22
5/1 JOB CONSTRUCTION REPORT	22
5/4 WORKS COST STATEMENT – WORKS DEPARTMENT	27
5/5 WORKS DEPARTMENT MAINTENANCE REPORTS	28
5/6 UPGRADING OF FRONT DECK MOWERS	30
5/7 JOB CONSTRUCTION PROGRAMME	31
SECTION 6: WORKS DEPARTMENT - GENERAL BUSINESS	32
SECTION 7: WORKS DEPARTMENT - LAND PROTECTION	32
7/1 LAND PROTECTION MONTHLY REPORT.....	32
FROM: LANDS PROTECTION SUPERINTENDENT – MR T HUCKSTEPP	32
REPORT: (LANDS PROTECTION SUPERINTENDENT – MR TROY HUCKSTEPP)	32
RECOMMENDATION: (WORKS DEPARTMENT MANAGER – MR G. INGHAM)	33
SECTION 8: WORKS DEPARTMENT - LAND PROTECTION - GENERAL BUSINESS	33
SECTION 9: WORKS DEPARTMENT - PARKS & GARDENS	33
9/1 PARKS & GARDENS MONTHLY REPORT	33
9/2 WORKS COST STATEMENT – PARKS & GARDENS	34
SECTION 10: WORKS DEPARTMENT – PARKS & GARDENS – GENERAL BUSINESS	34
SECTION 11: WATER & SEWERAGE	35
11/1 WORKS COST STATEMENT – WATER & SEWERAGE	35
11/2 BIRD POPULATION AT THE TIN CAN BAY TREATMENT PLANT – MINUTE G37/01/08 REFERS	38
FROM: WATER & SEWERAGE MANAGER – I SCHIEFELBEIN	38
RECOMMENDATION: (WATER & SEWERAGE MANAGER – I SCHIEFELBEIN)	39
11/3 SEWER CONNECTION – 21 LANGARA DRIVE, GYMPIE.....	39
RECOMMENDATION: (WATER & SEWERAGE MANAGER – I SCHIEFELBEIN)	40
11/4 SEWER CONNECTION - 1 WATSON ROAD, SOUTHSIDE	40
RECOMMENDATION: (WATER & SEWERAGE MANAGER – I SCHIEFELBEIN)	41
11/5 SEWER CONNECTION – 3 PERRY LANE, SOUTHSIDE	42
FROM: MR D SABISTON, 270 BURGESS ROAD, CALICO CREEK, QLD 4570	42
RECOMMENDATION: (WATER & SEWERAGE MANAGER – I SCHIEFELBEIN)	42
11/6 DA11126 – KOUMALA ROAD PUMP STATION, LOT 1 RP73188, KOUMALA ROAD SOUTHSIDE	43
FROM: WATER & SEWERAGE MANAGER – I SCHIEFELBEIN	43
RECOMMENDATION: (WATER & SEWERAGE MANAGER – I SCHIEFELBEIN)	44
FROM: WATER & SEWERAGE MANAGER – I SCHIEFELBEIN	44
RECOMMENDATION: (WATER & SEWERAGE MANAGER – I SCHIEFELBEIN)	45
SECTION 12: WATER & SEWERAGE DEPARTMENT - GENERAL BUSINESS	46
SECTION 13: HEALTH & COMMUNITY SERVICES DEPARTMENT	46

13/1	PIGEON PROBLEM THROUGHOUT THE SHIRE – MINUTE G57/12/07 REFERS	46
13/2	UNUSUALLY LOW BIRD NUMBERS – MINUTE G48/01/08 REFERS	47
13/3	PETITION WASTE MANAGEMENT, LANGSHAW – MINUTE G51/01/08 REFERS	47
SECTION 14:	HEALTH & COMMUNITY SERVICES DEPARTMENT - GENERAL BUSINESS	48
SECTION 15:	ATTACHMENTS	48
SECTION 16:	IN COMMITTEE MATTERS.....	49

LEAVE OF ABSENCE / APOLOGIES

Cr J. Watt has been granted leave of absence from today's meeting (G69/01/08 refers)

APPOINTMENT OF PROXY/DELEGATE

Recommendation: (Director of Engineering – R.A. Fredman)

That Cr I.T. Petersen be appointed the Proxy/Delegate due to the absence of Cr J. Watt.

CONFIRMATION OF PREVIOUS MEETING

Recommendation: (Acting Chief Executive Officer, Mr C. Manson)

That the Minutes of the Works & Services Committee Meeting held on the 15 January 2008 be taken as read and confirmed.

SECTION 1: DIRECTOR OF ENGINEERING

1/1 Borumba Dam Water Storage

Re: Borumba Dam Water Storage
From: Director of Engineering, Mr R.A. Fredman
File: CG99/00178
Date: 30 January 2008

Report: (Director of Engineering – Mr R.A. Fredman)

As of the **21 January 2008**, Borumba Dam is at **68%** of its water storage capacity.

Recommendation: (Director of Engineering – Mr R.A. Fredman)

Recommend that the information be received.

1/2	Capital works, maintenance, design and DMR contract works - Amamoor
-----	---

Re: Capital works, maintenance, design and DMR contract works - Amamoor
From: Michael & Angela Brady
File: WR07/00710 DOC ID: 869974
Date: 18 January 2008

We live at 22 Mary Street, Amamoor. We have been living with no curbing since we took residence with our place almost four years ago. During this time, especially with the amount of rain we have had these last couple of months, we have noticed that there is a lot of water sitting on the road days after the rain 'gutter' for the water through the water would not sit on the road the way it does now.

Further we feel that Council is not conducting adequate checks of the drainage that they have installed. We have a pipe out the front of our place and it is $\frac{3}{4}$ choked with grass etc. No wonder we have problems with cane toads and mosquitoes. I believe that if you come and check out the drain pipe you might also like to take a look at Busby Street. Both sections of road look like there is scum living in the system as they are never drained properly. Busby Street probably looks worse due to the fact that they have curbing.

On another matter not related to the above we would like to thank Council for their prompt response in getting the hedges and grass trimmed at the entrance of Amamoor. It makes visibility a lot easier now. As a suggestion, as the intersection here is ridiculous, could an alternation/upgrade of this section be made due to the nature of the positioning of the intersection.

Finally if Council could please advise whether they are responsible for the Mary Valley Highway's maintenance. In particular the section of road where Blackgate Road joins as well as the road to the Traveston Bridge. If Council are responsible for this road, we would like to know why the road was 'repaired' (more like resurfaced, in our opinion made worse than it was) prior to the Muster 2007 and it is now January 2008 and there are no line markings on the road. This makes it very difficult to see whilst driving in the dark or worse, in the rain.

Report: (Director of Engineering – Mr R.A. Fredman)

The letter raises issues about capital works, maintenance, design and DMR contract works.

Recommendation: (Director of Engineering – Mr R.A. Fredman)

Recommend that the writer be advised that:

1. **Kerb and channel is recognised as being an efficient road drainage solution, however, it is very expensive. Council has no plans for further kerb and channel work in Amamoor. Note that the works on Kandanga-Amamoor Road were necessitated by an ongoing scour problem which is generally given priority;**
2. **The drainage pipes in Mary Street and Busby Street will be checked and maintenance carried out as necessary;**
3. **The intersection has a low crash record, which makes investment in an upgrade to a tee intersection a low priority;**
4. **Council was not involved in the work on the Mary Valley Road adjacent Blackgate Road. This was handled entirely by Main Roads and their contractors. Consequently this letter has been forwarded on.**

1/3

Revenue Collected from Speed Camera Fines

Re: Revenue Collected from Speed Camera Fines
From: Local Government Association of Queensland Inc PO Box 2230,
Fortitude Valley BC 4006
File: WR94/00018 Doc ID 869960
Date: 18 January 2008

Thank you for your letter of 17 December 2007 regarding the revenue collected from speed camera fines.

The State Government has advised that revenue raised from fines arising from camera detected offences is used for:

- *Road safety education*
- *Road accident injury rehabilitation programs; and*
- *Road funding to improve the safety of the sections of state-controlled roads where crashes happen most frequently.*

Although as you point out local governments are not receiving direct benefits from the revenue collected, their communities are however receiving benefits in terms of increased funding overall for road safety activities throughout Queensland.

If you consider that a percentage of the revenue should be paid directly to local governments I would encourage you to formally raise this issue as a motion at the 2008 Annual Conference.

Report: (Director of Engineering – Mr R.A. Fredman)

Council's letter of 17 December 2007 is reproduced below. The LGAQ suggestion of direct payment of speed camera revenue to local governments raises some interesting questions. Would this Council request more speed cameras to increase road funding?

"I write at the direction of Council to request your Association write to the State Government asking that they consider granting a percentage of the revenue collected from speed camera fines, to be on-forwarded to Queensland Local Governments to assist in the upkeep of local roads.

This matter was discussed at a recent meeting of Council where concern was expressed about the Governments' expectations of raising enormous funds following the installation of fixed speed cameras throughout Queensland and Council feels that a percentage of this revenue, together with that already raised from speed cameras, should be made available for the upkeep of local roads.

Should you wish to discuss this matter further, please contact the undersigned."

Recommendation: (Director of Engineering – Mr R.A. Fredman)

Recommend that Council take no further action on the basis that increased funding overall for road safety activities throughout Queensland is satisfactory.

1/4	Speed Restriction Bruce Highway, Chatsworth – Minute G71/01/08 refers
-----	---

Re: Speed Restriction Bruce Highway, Chatsworth – Minute G71/01/08 refers

From: Director of Engineering – R.A. Fredman

File: WR98/00249

Date: 30 January 2008

Minute G71/01/08 of the General Meeting held on 22 January 2008 resolved:

That the correspondence be received and referred to the Works & Services Committee Meeting to be held on 5 February 2008 for further discussion.

Report: (Director of Engineering – Mr R.A. Fredman)

Eighty-similar letters have been received from the Chatsworth community.

Recommendation: (Director of Engineering – Mr R.A. Fredman)

Recommend that in view of the very strong feeling in the community, Council request the District Director of Main Roads to attend a Council Meeting to discuss measures that will be undertaken by Main Roads to improve the safety of the Bruce Highway through Chatsworth.

1/5	Reduction in Maintenance Bond – Stage 2 – D Brighton Development – Old Maryborough Road, Gympie – Minute G62/01/08 refers
-----	---

Re: Reduction in maintenance bond – Stage 2 – D Brighton Development – Old Maryborough Road, Gympie – Minute G62/01/08 refers
From: Northern Resources Pty Ltd. 19 Channon Street, Gympie 4570
File: DA13662 DOC ID:861725
Date: 30 January 2008

Minute G62/01/08 of the General Meeting held on 22 January 2008 resolved:

That Recommendation P13/01/08 of the Recommendations of the Planning & Development Committee Meeting held on 15 January 2008 be deleted and that the Director of Engineer be requested to table a report on the development which may affect the reduction of the maintenance bond to the next Works & Services Committee Meeting to be held on 5 February 2008.

Report: (Director of Engineering – Mr R.A. Fredman)

There are two methods by which Council gains surety that works for subdivision will perform satisfactorily in the long term.

Firstly, the release of plans is withheld until all conditions are met and all known defects rectified. Secondly, a bond is retained in case unknown defects are present in the work.

In the case of the Brighton subdivision, the siltation problems are known and will be rectified before the plans are released. Similarly, the finished surface profile will be in accordance with the approved plans.

The 10%/2 year retention recommendation is based on a range of parameters including performance history. It remains consistent with previous decisions.

Recommendation: (Director of Engineering – Mr R.A. Fredman)

Recommend that the maintenance bond for Stage 2 of D Brighton's development at Old Maryborough Road Gympie be 10%/2 years.

1/6

White Bridge, Tin Can Bay Road

Re: White Bridge, Tin Can Bay Road
From: Department of Main Roads, PO Box 183, Gympie Qld 4570
File: WG96/00119 DOC ID: 872035
Date: 21 January 2008

Thank you for your letters of 14 December 2007 and 16 January 2008 about 'Whites Bridge' on the Tin Can Bay Road.

Historically the bridge over Deep Creek has been called 'Whites Bridge' for a long period of time. Prior to the upgrade of the Tin Can Bay Road in November 2002 the old timber bridge, replaced during the upgrade, was also signed 'Whites Bridge'. Main Roads has found no other records indicating the origin of the name of the bridge.

Main Roads asks Cooloola Shire Council to endorse any name change and provide clear advice of the preferred name.

Report: (Director of Engineering – Mr R.A. Fredman)

Evidence has been discovered in early Gympie Times and Widgee Shire Council minutes that the bridge was known originally as White Bridge.

Recommendation: (Director of Engineering – Mr R.A. Fredman)

Recommend that Council advise the Department of Main Roads in the interest of historical correctness, Council endorses the name White Bridge, and enclose records accordingly.

1/7

Road Maintenance – Lucky Road, East Deep Creek

Re: Road Maintenance – Lucky Road, East Deep Creek
From: Tracie and Ray Farrugia, 39 Lucky Road, East Deep Creek
File: WR94/00018 DOC ID: 867287
Date: 10 January 2008

“We are residents and current rate payers of 39 Lucky Road, East Deep Creek and would like to know how or who we need to make contact with regarding putting our road onto a maintained roads list at the Cooloola Shire Council?”

There are other residents living on this road and users of this road that access their properties via Lucky Road.

Our road is in much need of maintenance and we feel that this needs to be addressed as it is dangerous in its present state and is inaccessible in wet weather by normal car.

How did the Council give approval for subdivision without contribution for the road to be brought to standard?

The access to Lucky Road is also of concern and would like to bring to your attention the entrance of Lucky Road. It is difficult to exit as the vision from the left at East Deep Creek Road is obstructed by a crest & makes visibility poor. The entrance at present from the right is poor as it is obstructed by a corner. This also gives poor visibility.

We believe the present entrance is not as per specified by maps. We feel concern as this is dangerous to drives exiting Lucky Road and for drivers using East Deep Creek Road.

We would like this problem referred to the works and services committee as soon as possible.

Can they please have a look at our concerns as listed above as it is dangerous. Please ring to make an appointment before anyone gets hurt. We can be contacted on the following numbers Ray at Work – 54828297 or Tracie 0438 783029 or Home 54866011.

If the Cooloola shire Council has NO intention to upkeep the road we ask Council to forgo our rates?

We are looking forward to a reply regarding our concerns.”

Report: (Director of Engineering – Mr R.A. Fredman)

Council's policy places the onus on upgrading unmaintained roads onto the landowners who bought the properties unless Council determines that public funds will be used.

Recommendation: (Director of Engineering – Mr R.A. Fredman)

Recommend that Council's Policy regarding the upgrading of unmaintained roads be forwarded to the writer.

Further, point out that a program is being developed for the continued upgrading of East Deep Creek Road as funds permit.

1/8	Bruce Highway, Monkland
-----	-------------------------

Re: Bruce Highway, Monkland
From: Department of Main Roads, PO Box 183, Gympie Qld 4570
File: WM96/00033 DOC ID: 867356
Date: 8 January 2008

“Thank you for your letter of 13 November 2007, about safety concerns with the Bruce Highway at the intersections of Old Imbil Road and Nicholas Christopher Drive.

The Department of Main Roads maintains an intersection priority list that ranks intersections on the basis of historical crash costs. Crash costs are calculated from crash data recorded over a five-year period and the list is updated annually. Main Roads uses this list to allocate funding to improve intersections on a priority basis. Main Roads also monitors congestion and delays at intersections, and ranks them accordingly.

I have been advised that these particular intersections do not rank highly on the basis of crash cost or congestion. It is also worth noting that visibility at both intersections provides sufficient distance for a driver of a vehicle on the Bruce Highway to observe a vehicle entering or leaving either of these minor roads and if necessary, decelerate to a stop before reaching the collision point.

There are many intersections in the North Coast-Hinterland District that would benefit from upgrading works, however funding is limited and is currently allocated to other intersections that demonstrate a much greater need. Main Roads will continue to review intersection priorities on an annual basis to take into account any changed conditions at each site.”

Report: (Director of Engineering – Mr R.A. Fredman)

Council's letter of 13 November 2008 is reproduced below:

“Council at its October meeting discussed a serious concern regarding the safety of the Bruce Highway at the Old Imbil Road/Nicholas Christopher Drive intersection. There have been several reports of near-crashes involving cars turning to and from these roads.

Would you please review the safety of this intersection and advise Council of any improvements you may plan to undertake.”

Main Roads is consistent with their replies to this type of request. They accept the risk of accidents at this intersection because budget allocations are directed to higher priority sites based on their selection criteria.

Recommendation: (Director of Engineering – Mr R.A. Fredman)

Recommend that the report be received.

1/9	Moy Pocket Road
-----	-----------------

Re: Moy Pocket Road
From: Warren Pitt MP, Member for Mulgrave, Minister for Main roads and Local Government
File: WR94/00076 DOC ID: 867300
Date: 8 January 2008

“Thank you for your letter about Moy Pocket Road.

The Honourable Warren Pitt MP, Minister for Main Roads and Local Government, has asked that I respond on his behalf.

I am advised the quarry is located on Moy Pocket Road which is not a state-controlled road. This road instead falls under the jurisdiction of Maroochy and Cooloola Shire Councils. It is also a Local Road of Regional Significance in the SUNROC and Cooloola Regional Roads Group under the Roads Alliance.

As you are aware, the Department of Main Roads provides funding to the Regional Roads Groups through the Transport Infrastructure Development Scheme (TIDS). In the Roads Implementation program 2007-08 to 2011-12 (RIP), the priority roads projects nominated by Cooloola Shire Council for Moy Pocket Road received a total contribution of \$653 000. Further funding under the Regional Roads Group allocation will not be available until 2008-09.

For your information, to improve road safety for motorists within the area, the state government has been progressively upgrading Eumundi - Kenilworth Road over the past 10 years, including funding for the replacement of bridges at Belli Creek Crossing No. 1 and 3 and Eerwah Creek.

The state is continuing to invest in this important link road, with the department's forward program allocating a further \$15.4m to upgrade sections of this road. These improvement works will include replacement of the narrow bridge and road approaches at Belli creek Crossing No. 2 in mid-2008 and widening and resurfacing work between Archer Road and Belli Creek Crossing No. 1 to follow in mid-2009.

The department has also allocated an additional \$1.5m towards a large scale maintenance program to carry out short-term safety improvements on Eumundi – Kenilworth Road. This increase in routine maintenance will keep the road in a safe condition until major upgrading works are able to be undertaken. As part of the program, Main Roads will investigate opportunities for cost effective rehabilitation treatments and shoulder widening.”

Report: (Director of Engineering – Mr R.A. Fredman)

Clearly from the funds allocated for the State-controlled road (Eumundi-Kenilworth Road) compared with the Council-controlled road (Moy Pocket Road) there are major advantages in a road being part of the State network. However, Main Roads is most reluctant to expand the State network.

Council's letter was as follows:

“Council, at a recent meeting received a number of letters of concern relative to the condition of Moy Pocket Road and questioning Council as to what action was being taken to make this road safer for motorists who utilise the road on a daily basis.

Council resolved to write to you and request that in light of Moy Pocket Quarry being declared as a strategic regional resource under State Planning Policy 2/07 by the Minister for Local Government, Planning & Sport, that special funding over normal allocations be made available to make Moy Pocket Road fit for its purpose as a strategic regional resource access road that is safe for private motorists who also have to use this road.

Your advice in respect to above request would be appreciated.

Should you wish to discuss this matter further, please contact Council's Director of Engineering (telephone 5481 0655).”

Recommendation: (Director of Engineering – Mr R.A. Fredman)

Recommend that Council reply that due to the limited availability of Council funds to match TIDS funds, that Moy Pocket Road, as the designed transport route for the State Key Resource Area 89, be considered for direct State funding in the same manner as Eumundi-Kenilworth Road.

SECTION 2: DIRECTOR OF ENGINEERING - GENERAL BUSINESS**SECTION 3: DESIGN DEPARTMENT****3/1 Road Name – Unformed Road Reserve, Widgee Crossing South**

Re: Road Name – Unformed Road Reserve, Widgee Crossing South
From: Colin Buchan, PO Box 126, Tewantin 4565
File: DA10927 Doc ID 867233
Date: 8 January 2008

“I have recently received Endorsement of Plans for the above application number.

I am now requesting that the unnamed road be named and allocated postal address numbers, for Lots 27, 29, 28 & 26 Buchan’s property and Lot 21 on W3761 Coll’s property as we all live on the unnamed road.

After discussion with council staff, the name suggestions are:

*Coll’s Lane or Road
Buranda Lane or Road
Buchan Lane or Road*

Naming the road JAMES DEAN ROAD EAST will cause nothing but confusion as well as numbering problems.

I await your reply.”

Report: (Design Department Manager – Mr R. Chapman)

A previous request to name this road as per Minute W09/04/07 was determined by Council to differ from the staff recommendation and for the road to be a continuation of James Dean Road.

The applicant wishes to rename the road to better utilise the house numbering along James Dean Road (see map below).

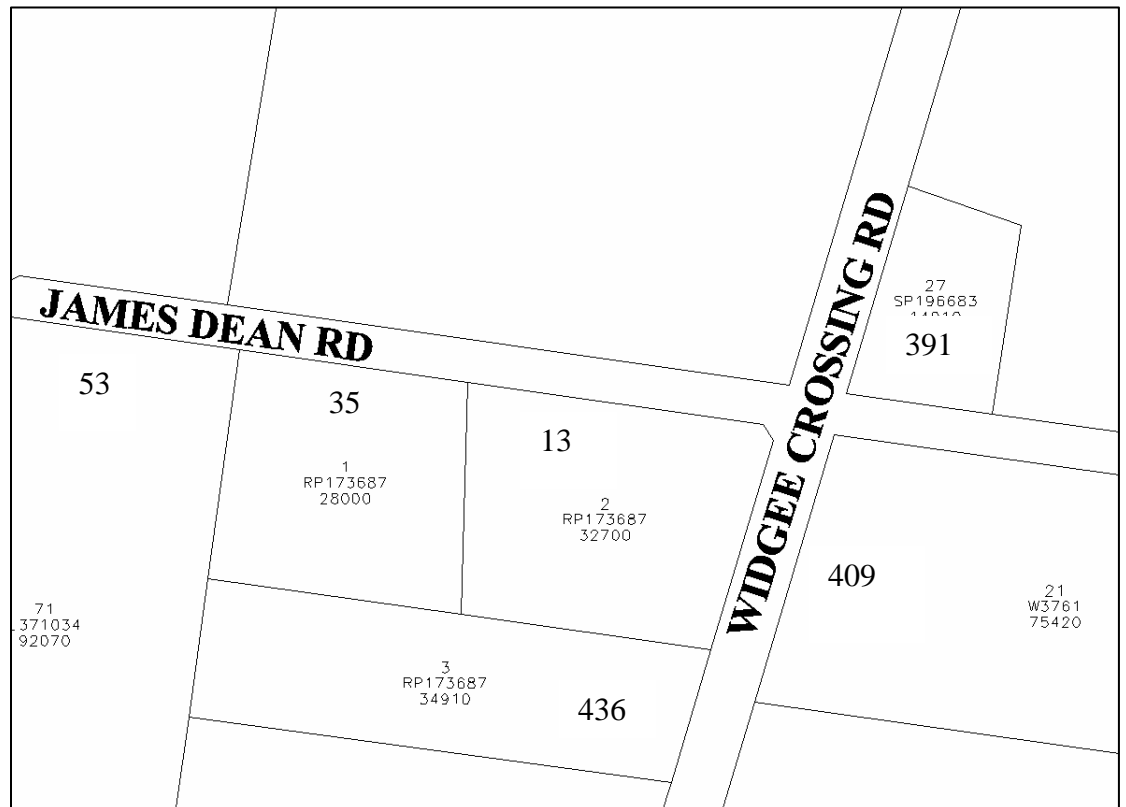

It is therefore recommended that the previously suggested road name “Buranda Road” be accepted to rename the eastern section of James Dean Road off Widgee Crossing Road. This name has local significance, as it was the name of the original property brought by the Coll family in the 1950’s.

The suggested road type is in keeping with Council Roads & Street Naming Policy.

Recommendation: (Design Department Manager - R. Chapman)

Recommend that Buranda Road be approved for the section of James Dean Road on the eastern side of Widgee Crossing Road and the name be submitted for advertising according to Council’s Road & Street Naming Policy PR-D-004.

3/2	Proposed Road Name off Van Doren Road – Opus Qantec McWilliam
-----	---

Re: Proposed Road Name off Van Doren Road – Opus Qantec McWilliam
From: Opus Qantec McWilliam
File: DA17485 DOC ID: 853459
Date: 25 October 2007

Report: (Design Department Cadet Technical Officer – T.L. Johnston)

It is recommended that the following proposed road name be approved for the subdivision over Lots 11 & 12 RP183428, Van Doren Road, Southside (DA17485):-

Danchia Court

The supplied name has been submitted for public comment according to Council's Roads & Streets Naming Policy PR-D-004. No submissions were received either for or against the proposed name, and is therefore recommended.

Recommendation: (Design Department Manager - R. Chapman)

Recommend that Council approve the road name Danchia Court for the cul-de-sac of this development off Van Doren Road, Southside

3/3	Traffic Advisory Committee Meeting
-----	------------------------------------

Re: Traffic Advisory Committee Meeting
From: Design Department Manager – R. Chapman
File: AG94/00051
Date: 16 January 2008

Report: (Design Department Manager - R. Chapman)

The record of the Traffic Advisory Committee Meeting held on 3 December 2007 has been distributed to committee members and is attached to this agenda.

Outcomes from the meeting were advised at the December Council Meeting and have been put in place.

See Attachment One: Record of Traffic Advisory Committee Meeting

Recommendation: (Design Department Manager - R. Chapman)

Recommend that the information be received.

3/4	Speed Limit in Watt Street, Gympie - Minute G32/12/07 refers
-----	--

Re: Speed Limit in Watt Street, Gympie – Minute G32/12/07 refers
From: Design Department Manager – R. Chapman
File: WR97/00197
Date: 30 January 2008

Minute G32/12/07 recommended that the Director of Engineering be requested to investigate ways to reduce traffic speed in Watt Street leading towards Woolworths and that a report on same be tables to Council at a future Works & Services Committee Meeting.

Report: (Design Department Manager - R. Chapman)

A review was made of traffic volumes around the Centro development in December 2007 for comparison with past traffic and predicted traffic movements.

There has been a significant increase in Watt Street traffic that could warrant some control measures. However, any such measures need to be “anti-hooning”. This could be effected however by reversing the priorities at the Kidgell Street intersection to provide stop signs on the Watt Street legs and where Watt Street enters River Road and Hughes Terrace (including Crawford Street opposite).

Recommendation: (Design Department Manager - R. Chapman)

Recommend that Council places stop signs on Watt Street at River Road intersection, Kidgell Street intersection and Hughes Terrace intersection.

Further that Crawford Street opposite Watt Street be fitted with a stop sign.

3/5	Stormwater & silt problems - Minute G74/12/07 refers
-----	--

Re: Stormwater & silt problems – Minute G74/12/07 refers
From: Design Department Manager – R. Chapman
File: WW97/00036 & WW94/00003
Date: 30 January 2008

At the General Meeting of Council held on 22 January 2008 Council resolved vide Minute G74/01/08:

That the Director of Engineering be requested to provide a report to the next Works & Services Committee Meeting on stormwater and silt problems of Mr David Mason of 23 Berrie Street, Gympie; Mr Brian Whitfield of Illustrious Drive, Cooloola Cove and Mr Chris Thomas of David Road, Gympie.

Report: (Design Department Manager – Mr R. Chapman)

23 Berrie Street, Gympie; Mr David Mason

There is an open drain at the head of Nash Gully between Tucker Street and Ray Street that has been in existence for many years without any drainage easements in place for well known reasons. The last time of contact with the owners they were advised to seek the support of all affected properties to put forward a case to Council for some form of upgrade. There has been no contact with staff since. The project has been listed on the potential list of drainage projects for Gympie for a considerable period.

Illustrious Court, Cooloola Cove; Mr Brian Whitfield

Minute W61/10/06 addressed an issue related to the drainage of Illustrious Court cul de sac and rating it as a very low priority. Recent submission of photographs have been referred to the Works Department for confirmation of what appears to be neighbourhood house drainage issues.

David Road, Gympie; Mr Chris Thomas

Meetings have been held with Mr Thomas and letters written to the contractor most recently on December 2007 to undertake remedial works to the dam.

Recommendation: (Design Department Manager - R. Chapman)

Recommend that the information be received

3/6	Proposed Illuminated Street Name Sign – Corner of Excelsior Road & Hyne Street, Gympie
-----	--

Re: Proposed Illuminated Street Name Sign – Corner of Excelsior Road & Hyne Street, Gympie
From: Claude Neon (Aust) Pty Limited
File: AG99/00454 DOC ID: 793884
Date: 30 January 2008

“We hereby request permission to install a new Identilite at the above location.

This is not located on a declared Main Road, so we will not be applying to Main Roads.

We look forward to Council's early consideration of this application. Please do not hesitate to contact me, on 3267 1050 if you have any queries."



Report: (Design Department Technical Officer – A.C. Walsh)

The Claude Group Pty Ltd has an agreement with Council for the placement of Illuminated Street Name Signs in the old Gympie City area.

The proposed position of the said sign is at the corner of Excelsior Road and Hyne Street with advertising on the sign being for Hungry Jack's.

The Planning Department advise application (DA17402) which includes the entry/exit to Hyne Street for the Hungry Jack's development has not been approved at this stage. Therefore Council should only approve the siting of the sign at this stage with the installation of the sign being placed on hold until the above development application (DA17102) is finalised.

Recommendation: (Design Department Manager - R. Chapman)

Recommend that Council advise Claude Neon Pty that the siting of the proposed sign is approved subject to the installation of same being placed on

hold until further advice is received from Council that the Hungry Jack's entry/exit to Hyne Street is approved and completed.

3/7

Future Roads & Drainage Capital Works Budgets

Re: Future Roads & Drainage Capital Works Budgets
 From: Design Department Manager – R. Chapman
 File: FF05/00079
 Date: 31 January 2008

Report: (Design Department Manager - R. Chapman)

The Director of Engineering and the writer believe it prudent to put forward at this time future funding requirements for the above Works Programs based on those previously funded for Cooloolo Shire. Both Tiaro and Kilkivan Shires have similar forward programs in place.

The attached table shows such a program, tailored to meet urban and rural categories.

COOLOOLA SHIRE COUNCIL ROAD BUDGETING OVER PAST YEARS AND 2008/09 and beyond FORWARD PROGRAM

BUDGET CATEGORY	2004/05	2005/06	2006/07	2007/08	2008/09	2009/10	2010/11	2011/12	2012/13
Roads Maintenance	3033	2582	2952	3151	3310	3310	3310	3310	3310
(actual)	2901	2515	2806	1602					
Green Maintenance	1164	1243	1329	1451	1530	1530	1530	1530	1530
(actual)	1137	1257	1350	930					
Sub Totals	4197	3825	4281	4602	4840	4840	4840	4840	4840
(actual)	4038	3772	4156	2532					
Reseals		643	658	728	990	990	990	990	990
(actual)		660	659	48					
Capital Works									
Arterial	220	500	100	107	100	100	100	100	100
Rural	786	1274	945	940	800	800	800	800	800

Coast	344	592	550	450	450	450	450	450	450
Urban Roads	609	143	392	239	200	200	200	200	200
Urban SWD	34	91	63	350	300	300	300	300	300
Urban Overlays	90	390	115	231	470	470	470	470	470
Urban Rehab					255	255	255	255	255
Bridge Works	240	370	787	741	500	500	500	500	500
Sub Total	2323	3360	2952	3058	3075	3075	3075	3075	3075
Major Projects- Loan					73	146	146	146	146
TOTALS	6520	7828	7891	8388	8978	9051	9051	9051	9051

Recommendation: (Design Department Manager - R. Chapman)

Recommend the attached table be endorsed by Council as a desirable level of funding to be directed towards the Roads and Drainage Works Program.

SECTION 4: DESIGN DEPARTMENT - GENERAL BUSINESS

SECTION 5: WORKS DEPARTMENT (ROADS/ DRAINAGE/PLANT)

5/1 Job Construction Report

Re: Job Construction Report
 From: Works Department Manager, Mr G. Ingham
 File: FF94/00018
 Date: 29 January 2008

Report: (Works Department Manager – G.C. Ingham)

2007/08 RESEAL PROGRAM \$725,000

Job has been assessed and measured.

Resealing works have been commenced.

CORELLA ROAD CULVERT UPGRADE – STAGE 2

The works involve removing the existing cross road drainage, installing three RCBC and associated rehabilitation works upstream of stage released previously. It is envisaged that the works are to be constructed under traffic, with the culverts built in two stages either side of the base slab contraction/construction joint. This will involve minor sidetracks to be built on the existing verges.

Work is largely complete. Some tidy up work still outstanding and upstream drainage work by developers.

DRAINAGE UPGRADE – SANTA MARIA COURT

The works include upgrading of drainage in Santa Maria Court up to the value of \$25,000.

Job complete.

DRAINAGE UPGRADE – OBERON COURT

The works include upgrading of drainage in Oberon Court up to the value of \$10,000. This work will commence at the completion of Santa Maria Court drainage works.

Job complete.

DISABILITY STANDARDS FOR ACCESSIBLE PUBLIC TRANSPORT

Alterations to various bus stops around the Gympie CBD, Tin Can Bay and Rainbow Beach areas will be undertaken to upgrade disabled facilities in accordance with Australian Standards, Design for Access and Mobility.

Work has commenced.

MOY POCKET ROAD UPGRADE

Road pavement complete, line marking still to be done. Box culvert extension still in progress.

PURCELL ROAD WIDENING

The works involve the widening and resealing of an existing section of Purcell Road. Includes placing gravel pavement, bitumen sealing, possible extension of cross road culverts. Reinstatement of driveway accesses, and removal and erection of signs

First coat of seal has been completed.

TAGIGAN ROAD SEALING

The works involve the widening and resealing of an existing gravel section of Tagigan Road. Includes trimming existing materials, placing gravel pavement, bitumen surfacing, and extension of cross road culverts, reinstatement of driveway accesses and a full width seal.

Work commenced, with Stage 1 due for completion February 2008 and Stage 2 March 2008.

DUKE STREET / OAK STREET ROUNDABOUT

The works to be carried out include widening existing roadway, replacing K&C, construction driveover concrete islands, construction patterned concrete islands, AC overlay, installing stormwater drainage pipes, grated catchpits, manhole and headwalls, construction pram ramps, and concrete footpath, erecting signage and painting linemarking.

First stage removal of 4 large Pine trees completed 7 January 2008. Project due for completion February 2008.

2007/2008 OVERLAY PROJECTS

Apollonian Valley, Graham Street and Mount Pleasant Road overlays are due to start in January 2008 depending on weather permitting.

Work has commenced.

HEIGHTS DRIVE STORMWATER

The works involve the placement of an additional stormwater pipe through the existing drainage easement at the intersection. The works include associated alterations to the existing pits and manholes, the placement of a new road gully unit, and reinstatement of the existing roadway and gardens.

Work commenced on 14 January 2008.

COOLOOLA COVE DRAINAGE ASSET RENEWAL

Cooloola Cove drainage works has commenced.

Recommendation: (Works Department Manager – G.C Ingham)

Recommend that the Job Construction Report, as presented, be received.

5/2

Walker Road Bridge

Re: Walker Road Bridge
From: Works Department Manager – G.C. Ingham
File: WR08/000740
Date: 29 January 2008

Report: (Works Department Manager – G.C. Ingham)

On 5th & 6th January 2008 Walker Road Bridge was severely damaged during flooding. The entire deck was lost and had to be replaced. The bridge is located on Walker Road a no exit road off Moy Pocket Road that services approximately 10 households. These households were effectively cut off by the loss of the bridge structure.

Council immediately activated a plan to restore access for these residents. This included the recall of staff from annual leave to work on the bridge and to upgrade an alternative track through private property to provide 4X4 access. Staff worked tirelessly in difficult circumstances to restore access. This included 10-12 hour work days, weekend work and work in or around a fast flowing river. Prevailing inclement weather conditions also hampered work.

The track was restored by Tuesday 15 January and the bridge opened to traffic on Friday 25 January 2008. This was an excellent achievement under the circumstances.

A number of staff were involved at various stages of the project in particular with the track upgrade. It is recommended that they be thanked for their commitment and effort. In particular 4 staff who worked on the bridge should be commended. It is recommended that the following staff be awarded a certificate of appreciation:

- Matt Boyd
- Barry Lindemann
- Noel Williams
- Ricky McBride

It is also recommended that the cooperation of two residents, Jo-anne Kildey and Gordon McMillan be acknowledged in allowing access for neighbours and Council across their properties.

Recommendation: (Works Department Manager – G.C. Ingham)

Recommend that the above report be received.

Further that the residents Kildey and McMillan be thanked for their cooperation.

Further than the bridge gang staff, Matt Boyd, Barry Lindemann, Ricky McBride and Noel Williams be awarded certificates of appreciation.

5/3

Monthly Rural Maintenance Report

Re: Monthly Rural Maintenance Report
From: Works Department Manager – G. Ingham.
File: WR94/00018
Date: 20/01/08

Report: (Works Department Manager – G. Ingham)

Recent road maintenance grading is as follows:

- Kress Road
- Chinaman Creek Road
- Ironstone Creek Road
- Happy Jack Creek Road
- Anderson Street (Brooloo)
- Western Creek Road
- Mitchell Creek Road (Both ends)
- Bella Creek Road (Patch grade)
- Henry Road
- Patch Grading Nall Road
- Calico Creek Road shoulders
- Heathcote Road
- Schacts Creek Road
- Melawondi Road
- Tunnel Road
- Barsby Road

At the time of writing, maintenance grading was planned for the following month, subject to weather conditions, on the following roads:

- Kandanga Creek Road (Patch Grade)
- Noakes Road
- Langshaw Area

Recent Drainage repairs carried out on the following roads.

- Chinaman Creek Road

-
- Kress Road
 - Ironstone Creek Road
 - Mitchell Creek Road
 - Cooloola Village drainage (Started and ongoing over the next month)
 - Green Trees Road
 - Sterling crossing Road
 - Bella Creek Road

Recent Tractor slashing carried out in the following areas.

- East Deep Creek area
- Wolvi area
- Sandy Creek area
- Anderleigh area
- North Deep Creek area
- Old Maryborough Road area
- Traveston area

Bridge Works carried out on Walker Road Bridge (Major Construction)

At the time of writing maintenance has been programmed for

- Spring Valley Road Bridge
- Woondoom Road Bridge

Sealed Road Pavement Repairs recently carried out on the following roads

- Moy pocket Road
- Kandanga Creek Road
- Bill James Road
- Bryant Road
- Noosa Road
- PineValley Road

Recommendation: (Works Department Manager- Mr G. Ingham)

Recommend that the Monthly Rural Maintenance Report, as presented, be received.

WORKS COST STATEMENT

Recommendation: (Works Department Manager – G.C. Ingham)

Recommend that the Road Maintenance, Road Construction and Road Contribution sections of the Works Cost Statement, as presented, be received.

5/5 Works Department Maintenance Reports

Re: Works Department Maintenance Reports
 From: Works Department Manager, Mr G Ingham
 File: WR94/00018
 Date: 30 January 2008

Report: (Works Department Manage – G.C. Ingham)

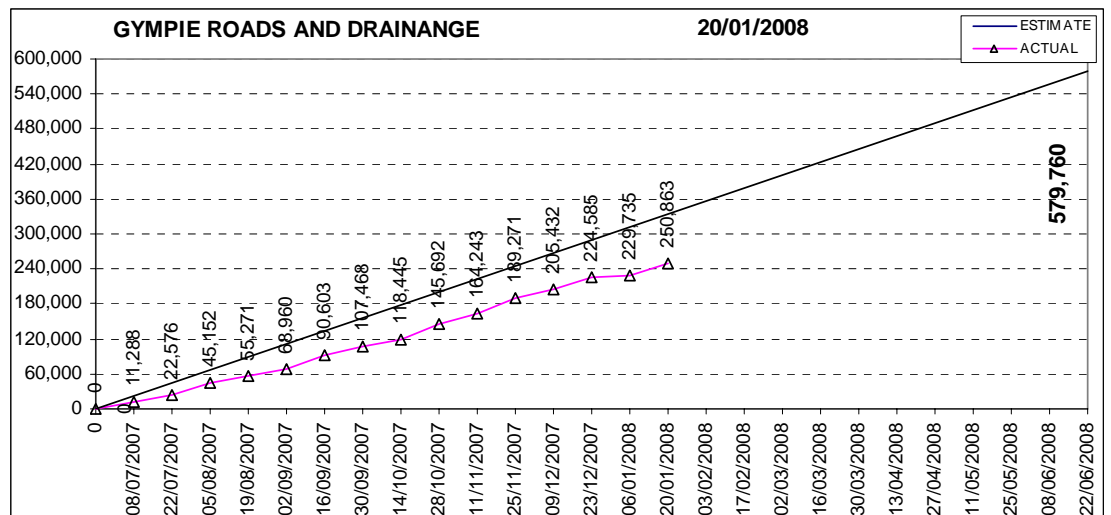

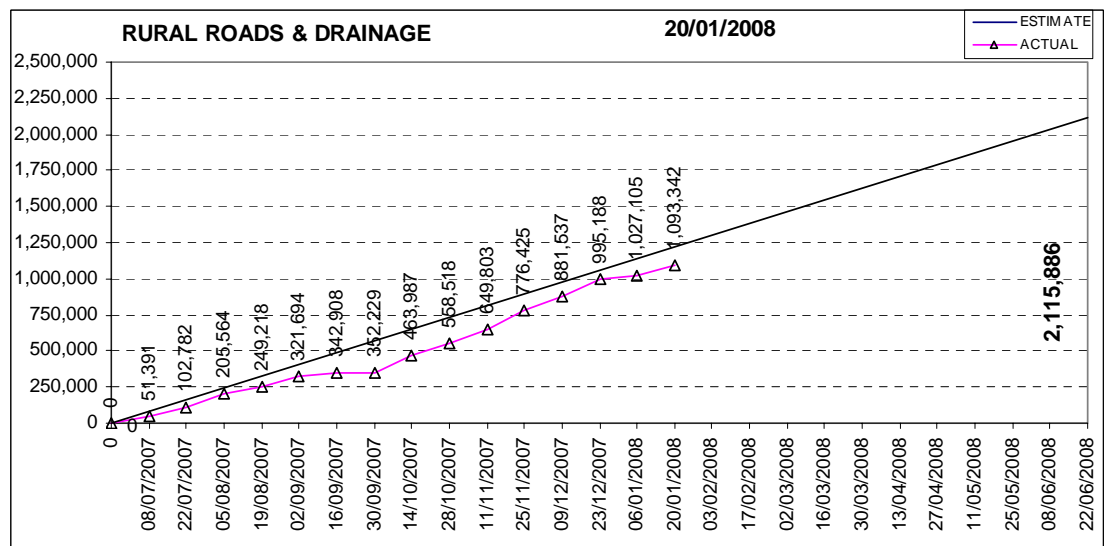
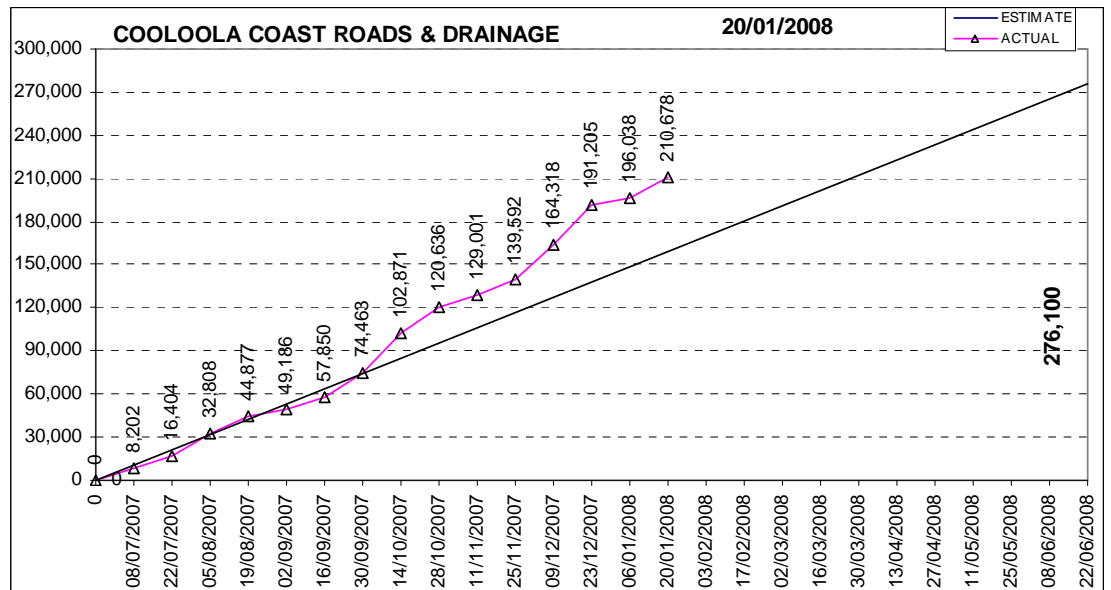

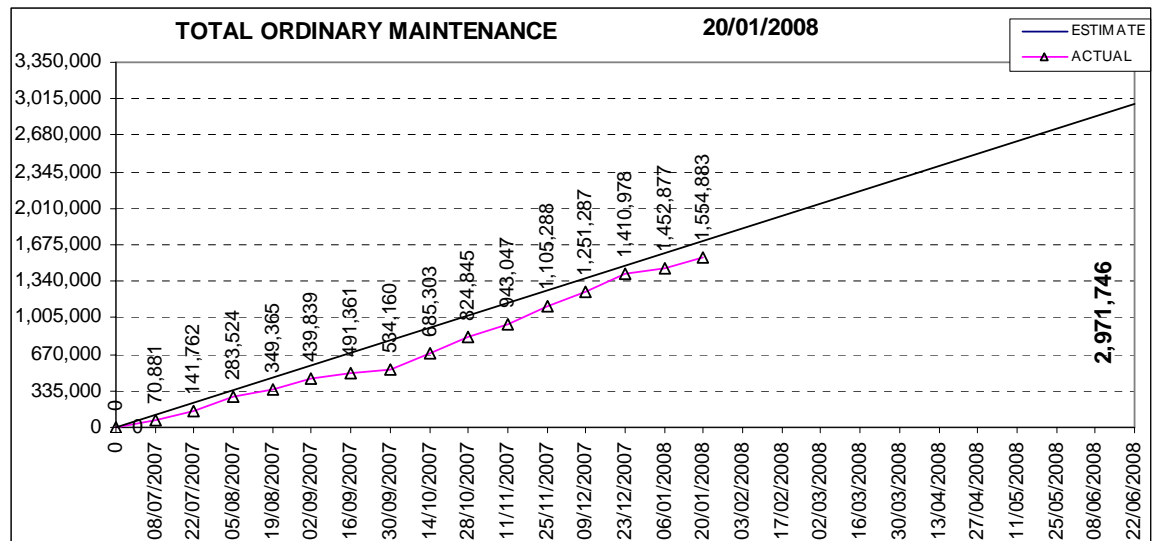

Recommendation: (Works Department Manager – G.C. Ingham)

Recommend that the Works Department Maintenance Reports, as presented, be received.

5/6

Upgrading of Front Deck Mowers

Re: Upgrading of Front Deck Mowers
 From: Works Department Manager, Mr G.C. Ingham
 File: WP95/00005B
 Date: 29 January 2008

Report: (Fleet Manager – P. Stevenson)

The 2007/08 budget has allowances for upgrading two of Council's front deck mowers.

1. Unit 332 – currently a 4WD 1820mm cut front deck mower, the allowance of \$90,000 is for a machine with a wider cut i.e. Wide Area Mower (WAM) specifications similar to the *Gianni Ferrari Unit 335*, 3200mm cut
2. Unit 339 – currently a 4WD 1820mm cut front deck mower the allowance of \$70,000 is for a similar capacity machine with grass catching capabilities

1820 mm front deck mowers are very versatile and have a very wide operational capability. Wide Area Mowers are generally designed to be a

‘finishing mower’ to cover large areas of grass. These machines are difficult to manoeuvre around trees and other obstacles. The operational capacity is limited to large flat well maintained areas such as playing fields and large open parks.

1. I foresee an issue with replacing Unit 332 with a WAM as it will reduce the flexibility of Council’s grass cutting fleet.
 - a. My suggestion is replace Unit 332 with *two* 1820mm front deck mowers the approximate cost per unit is \$37,500, a total outlay of \$70,000 would improve our flexibilities in the Parks and Gardens division and keep approximately \$20,000 in the budget
 - b. Our existing WAM has proven to a very effective tool in maintaining the large area parks and ‘quality’ reserves. During the growing season (late August through to mid April) this machine is capable of maintaining these areas on a weekly cycle. The areas are One Mile Sporting Ovals (2 cuts/week), Jack Stokes Oval (2 cuts/week), Normandy Hill Memorial Park (2 cuts/week), Albert Park, Lake Alford Park, Archery Park, Fisher Park and AJ Mitchell park.
 - c. The improvement in flexibility will offset any additional costs by adding another front deck mower to the fleet. These improvements will be realised through greater machine utilisation. The additional machine can work in conjunction with the WAM to complete the tighter and rough areas between trees, on banks and on road sides.

Recommendation: (Works Department Manager – G.C. Ingham)

Recommend that Council:

- 1 Purchase two (2) 1820 mm front deck mowers in place of one (1) Wide Area Mower reducing expenditure by approximately \$15,000 to \$20,000.**
- 2 Purchase one (1) 1820 mm front deck with catcher capabilities as per 2007-2008 budget.**

5/7

Job Construction Programme

Re: Construction Programme
From: Works Department Manager, G.C. Ingham
File: FF94/00018
Date: 30 January 2008

Report: (Works Department Manager – Mr G Ingham)

Recommendation: (Works Department Manager- Mr G. Ingham)

Recommend that the Construction Programme, as presented, be received.

SECTION 6: WORKS DEPARTMENT - GENERAL BUSINESS

SECTION 7: WORKS DEPARTMENT - LAND PROTECTION

7/1 Land Protection Monthly Report

Re: Lands Protection Monthly Report February 2008
From: Lands Protection Superintendent – Mr T Huckstepp
File: WG94/00077
Date 29 January 2008

Report: (Lands Protection Superintendent – Mr Troy Huckstepp)

Spraying ongoing on shire roads as follows:

Monkland Crusher, Main Roads – Tin Can Bay Road, Lawson, Pollock, Amy, Flynn, Rifle Range, Wilton, Cavanough, Bath, Tristram Bath, Eel Creek, Larkin, McIntosh Creek, Groundwater, North Deep Creek,

Noxious Weeds Issues:

A reminder has been mailed out to all landholders who have a known infestation of Parthenium. With the warmer wet weather around Parthenium will flourish and has the ability to grow from as a seed to setting seed every 21-28 days.

The Fireweed infestation on and around the rail line on the north-eastern part of Gympie is still growing and flowering (QR contractors are undertaking inspection and control measures). This infestation is a major concern because Fireweed has been known as a cool weather plant that diminishes in the summer months. If the growth pattern continues Land Protection staff could be possibly inspected for Fireweed all year round.

There are some large Groundsel infestations on the side of the roads. These sites will be sprayed over the coming months.

Hymenachne along Amamoor Creek looks like it will need to be sprayed within the next month to ensure it doesn't get into the Mary River.

Wild Dog Issues:

Residents in the Cedar Pocket area are establishing a baiting syndicate and should be ready for baiting sometime in February.

Feral Pig Issues:

There has been another 20 bounties paid under the trial scheme. More data has been collected. The Land Protection Unit has enough data on feral pig capture now that some educated and informed decisions are able to be made in terms of feed preference etc.

Other Issues:

The release sites for the Cats Claw Creeper biological control have been monitored and they all seem to be becoming established. The three sites for the biological control moth are yet to be serviced. This should happen in February.

Recommendation: (Works Department Manager – Mr G. Ingham)

Recommend that the Lands Protection Monthly Report, as presented, be received.

SECTION 8: WORKS DEPARTMENT - LAND PROTECTION - GENERAL BUSINESS

SECTION 9: WORKS DEPARTMENT - PARKS & GARDENS

9/1 Parks & Gardens Monthly Report

Re: Parks & Gardens Monthly Report
From: Parks & Gardens Superintendent, Mr E. French
File: EP94/00008
Date: 29 January 2008

Report: (Parks & Gardens Superintendent – Mr E. French)

The mowing and brush cutting of vegetation through out the shire remains the focus of Parks & Gardens staff. A contractor has been utilised for some works to assist in the challenge that the existing weather conditions present.

Parks staff have also assisted with the ongoing works resulting from the severe weather conditions experienced at Rainbow Beach and Tin Can Bay.

The vine planted on the wall in Young Street Gympie is *Thunbergia grandiflora*. This is a Class 2 declared weed and Council is required to remove it under the Lands Protection Act. Staff will do so when resources allow and replace with a suitable groundcover.

Mains Roads contractors, as part of Stage Two of the Highway upgrade, will remove the Graffiti wall, adjacent to the highway, in Nelson Reserve. It is within the existing road reserve. The new batter of the highway will start immediately adjacent to the western end of the basket ball court, with planting on the batter that will interfere with the retrieval of the ball etc. Investigations into costs of extensions of the court and construction of a replacement graffiti wall will be undertaken and reported to Council for consideration during budget deliberations.

Recommendation: (Works Department Manager – G.C. Ingham)

Recommend that the Parks & Gardens Monthly Report, as presented, be received.

9/2

Works Cost Statement – Parks & Gardens

WORKS COST STATEMENT**Recommendation: (Works Department Manager – G.C. Ingham)**

Recommend that the Parks & Gardens sections of the Works Cost Statement, as presented, be received.

**SECTION 10: WORKS DEPARTMENT – PARKS &
GARDENS – GENERAL BUSINESS**

SECTION 11: WATER & SEWERAGE**11/1 Works Cost Statement – Water & Sewerage****WORKS COST STATEMENT****Recommendation: (Works Department Manager – Mr I. Schiefelbein)**

Recommend that Water & Sewerage sections of the Works Cost Statement, as presented, be received.

11/2 Projects in Progress

Re: Projects in Progress
From: Water & Sewerage Manager – I Schiefelbein
File: WW00/00057
Date 30 January 2008

Report: (Water & Sewerage Manager – I Schiefelbein)**1. Tin Can Bay / Cooloola Cove & Rainbow Beach Sewage Treatment Plant Upgrading**

The tender of Abergeldie Construction Pty Ltd has been accepted for the construction of the three (3) sewage treatment plants. Work on the Cooloola Cove plant has commenced. Work on the Rainbow Beach plant is expected to start early in February.

2. Jones Hill Water Treatment Plant Upgrade

Work on the Jones Hill Water Treatment Plant is now planned to be implemented on a progressive basis. Initial works will involve site works, pipe diversion and raw water pump system upgrade. Excavation for site works has commenced. Work on the raw water pump system is expected to commence in early February.

3. Tin Can Bay / Cooloola Cove Trunk Water Main

SKM have carried out work to obtain all necessary approvals for the construction of the Teewah Creek Water Supply Trunk Main. A report has been submitted to the EPA. A preliminary response has been received and reviewed by Council officers. Following the review a response has

been sent to the EPA. Council awaits a further response from the EPA. A positive outcome is needed before water supply for Rainbow Shores Stage 2 can be finalised.

4. Site Based Management Plans (SBMP) & Receiving Environmental Management Plans (REMP).

Cardno's have completed draft SBMPs and REMPs for Council's Water and Sewerage system. Council officers are reviewing the draft documents.

5 Gympie Sewage Treatment Plant Design

Work is proceeding on the design of the Treatment Plant. A HAZOP meeting with the Consultants has been completed based on the preliminary design drawings

6 Waldock Road Pump Station and Rising Main

Waldock Road Pump Station has commenced. A concrete holding tank has been constructed. Sewage is currently being pumped from the pump well by a pump out waste contractor.

Work on the pump station is planned for completion in January 2008 or early February 2008.

7 Winnington Road Trunk Sewer

Tenders have been accepted for construction of the trunk sewer. The contractors (M & K Pipelines) have commenced work and are well advanced with the project. It is anticipated that the trunk sewer will be completed by February 2008.

8 Groundwater Road Sewerage Scheme

Tenders have been accepted and work on the trunk sewer and rising main by the Contractor Cooloola Civil Constructions work is substantially complete. It is expected that the contract will be complete by the end of February.

Work on the pump station by Council's Water and Sewerage Department new works gang is well advanced with fill around the pump station being obtained from the excavation work at Jones Hill water treatment plant

Work on the underbores under the Mary River is complete.

9. Gympie Sewage Transfer System Upgrade

Construction of the Gympie Sewage Transfer System pipeline by Eire Constructions is substantially complete. A tender has been accepted for the pump station upgrade. Quotations are now being obtained for the electrical upgrade.

10. Rainbow Beach Rising Main

The pipeline construction is substantially complete. The work on the Pump Station Upgrade is planned for February/March 2008.

11. CCTV Sewer Inspection Program

Tenders have been accepted for CCTV Inspection of Sewers in Gympie and Tin Can Bay by the contractor, RAIN.

12. Highway Water & Sewer Diversions

Tenders have been accepted for diversion of Pipework in the Monkland Street area required for the upgrade of the Bruce Highway by Eire Constructions. Work on this project has commenced.

13. Trade Waste

Due to the increasing number of sewer blockages due to grease and fat in the sewerage system an inspection program of grease traps and other facilities has commenced. The Trade Waste Inspection program has commenced in Rainbow Beach and Tin Can Bay. Staff availability has delayed the project.

14. Gum Tree Road Pump Station and Rising Main

Tenders have been accepted for the construction of sewers and rising main to service subdivisional developments adjacent Old Maryborough Road.

15. Stumm Road Overflow

Modifications have been made to the Stumm Road Pump Station overflow system to prevent overflow to a property owner's dam.

Recommendation: (Water & Sewerage Manager – I Schiefelbein)

Recommend that the above information be received.

11/3	Bird Population at the Tin Can Bay Treatment Plant – Minute G37/01/08 refers
------	--

Re: Dead Birds at the Tin Can Bay Sewage Treatment Plant – Minute G37/01/08 refers
From: Water & Sewerage Manager – I Schiefelbein
File:
Date 18 January 2008

Report: (Water & Sewerage Manager – I Schiefelbein)

There have been reports of low numbers of birds and dead birds at the Tin Can Bay Sewage Treatment Plant. An investigation has been carried out of potential causes for the unusually low number of birds, dead birds and a reduced insect population around the Tin Can Bay Sewage Treatment Plant.

From this investigation the following was determined:

- (a) The Water and Sewerage Department have not carried out any spraying activities or any other activities at the Tin Can Bay Plant within the last two (2) years.
- (b) The plant has operated normally without interruption and there have been no chemical additions at the plant.
- (c) The plant uses microbiological activity to stabilise the sewage. There has not been any noticeable change in this microbiological activity.
- (d) The final lagoons have significant amounts of aquatic marine life. There has not been any noticeable reduction in this activity.
- (e) There was a noticeable lower level of bird activity around the plant. There is no concern with respect to the previous high level of bird activity and the retention of this area as a haven for bird activity is supported.
- (f) Potential causes for the lower level bird activity could include:
 - (i) Recent high rainfall and cloudy conditions
 - (ii) High winds affecting insect density
 - (iii) Children/others visiting the site with stones/weapons disturbing the birds (No evidence currently exists however it is known to have happened in the past.)
 - (iv) Other more desirable sites for the birds.
 - (v) A combination of the above.
- (g) While there are occasional bird deaths at the sewage treatment plant, this would be expected due to the usually high number of birds at the plant. There has not been any detectable increase in bird deaths.

In summary the Water and Sewerage Department has not carried out any activity that would have caused reduced bird numbers or bird deaths at the Tin Can Bay Sewerage Treatment.

In the near future the construction of a new sewage treatment plant may affect bird numbers. This can be minimised by reducing access to the site.

Recommendation: (Water & Sewerage Manager – I Schiefelbein)

Recommend that:

1. **Any abnormal bird deaths immediately be reported to the EPA so that cause of death can be determined.**
2. **Access to the plant during construction and after completion of the new Sewage Treatment Plant be restricted ie. fences and gates.**
3. **Signs be erected restricting access to the site unless approved by Council Officers**

11/4

Sewer Connection – 21 Langara Drive, Gympie

Re: Sewer Connection – 21 Langara Drive, Gympie
From: Dale Keding, Director, Allweather Homes Cooloola, PO Box 270,
Gympie Qld 4570
File: WS95/00009 DOC ID:871407
Date: 22 January 2008

We The Keding Group Pty Ltd as the principal contractor of a new home at Lot 19 Langara Drive Gympie (SP 161200), Further to my telephone conversation with Mr Schiefelbein would like on behalf of our clients to request to be connected to or to receive a quote or any options you could provide us regarding to being connected to the new sewage line that is being constructed along side of the property on the Southside.

This approval or information would be much appreciated so that we could decide if this is a viable option before we lodge our plans to the building department or decide to go ahead with a treatment plant to service our clients new home.

Report: (Water & Sewerage Manager – I Schiefelbein)

The owner of this property at 21 Langara Drive has requested Council provide a cost to connect to sewerage. A trunk sewer is currently under construction on the opposite side of Langara Drive and some distance from the proposed building (which is currently under construction).

The property is outside the defined sewerage area..

Once the trunk sewer is completed the property could be connected to sewerage. The trunk sewer is expected to be complete within the next three (3) months. The estimated cost of a connection to this property is \$21,000.00.

The proposed design of this connection would also service two (2) other properties. If these other two (2) property owners contributed towards the cost then the cost for each of them would be considerably reduced. These two property owners would also however have to pay for the connection of their house drain to the sewer.

Council has not in the past applied infrastructure charges for connection of existing residential properties to sewerage.

In the future if these properties were sewerage Council's would pay the full cost of the sewer connection. Council may also at this time construct the house connection if that is the policy at that time. The timing and extent of any sewerage scheme in this area is unknown and subject to Council determination.

Recommendation: (Water & Sewerage Manager – I Schiefelbein)

Recommend that Council advise the Keding Group and the property owner that:

- (a) **The property at 21 Langara Drive can be connected to the sewerage scheme subject to the payment of \$23,000 (excluding gst) for the sewer connection;**
- (b) **If the other affected owners agree, the cost of the sewer could be shared;**
- (c) **Subject to the payment indicated in (a) above Council include the property in the defined sewerage area and construct the sewer.**

11/5

Sewer Connection - 1 Watson Road, Southside

Re: Sewer Connection - 1 Watson Road
From: Paul & Ann Maree Margetts, PO Box 60, Pomona Qld 4568
File: WS95/00009 DOC ID: 860801
Date: 10 December 2007

We are writing to request sewerage be connected to our block situated at 1 Watson road, Southside, my husband and I are in the process of having house plans drawn for this block.

The neighbouring block has been approved for subdivision and sewerage is being brought within a few metres of our land, so we felt it is a good opportunity to extend the sewerage line now rather than coursing disruption to the neighbours' property when they have finished. The property will have a church with sealed car parking and landscaped gardens, so after discussions with this neighbour (John Eade) it is much preferred to have all the sewerage works completed together.

Enclosed is a plan of the blocks we own at Southside, also is inclosed a plan showing the proposed future subdivision of these blocks. There is currently a realignment of the boundary between the blocks in Council at present. This had to be done now to enable us to fit our house on the block indicated as it was so narrow.

We will be eager to hear your response as to how we can make this happen.”

Report: (Water & Sewerage Manager – I Schiefelbein)

The property in question is adjacent to a proposed subdivision and development. As part of the development approval for this subdivision a new sewer is required which could be extended to service Mr & Mrs Margett's property as requested. The property is currently outside the defined sewer area.

The proposal is considered acceptable subject to work on the adjacent property being satisfactorily completed. Council has not changed infrastructure charges for connection of sewerage to existing residential properties in Southside.

It is expected that the property owners would arrange for the sewer extension directly with the developer at the adjacent property.

Recommendation: (Water & Sewerage Manager – I Schiefelbein)

Recommend that:

- 1. Mr & Mrs Margett's be advised that their property could be connected to sewerage provided.**
 - (a) A sewer is extended to their property at no cost to Council.**
 - (b) The sewer was installed, tested and operational before drains were connected.**
 - (c) Payment of standard sewerage connection charges (currently \$540.00).**
- 2. Subject to (1) above Mr & Mrs Margett's property be included in the defined sewer area.**

11/6	Sewer Connection – 3 Perry Lane, Southside
------	--

Re: Sewer Connection – 3 Perry Lane, Southside
From: Mr D Sabiston, 270 Burgess Road, Calico Creek, Qld 4570
File: WG99/00181 DOC ID: 857545
Date 27 November 2007

I refer to my recent discussion with Mr Ian Schiefelbein and confirm that I act on behalf of Islehaven Pty Ltd, owners of the above property. My client's are proposing to remove an existing dwelling from land at 55 Geordie Road, Monkland and relocate this building to 3 Perry Lane, Southside.

On behalf of my clients, I request that a sewerage connection be provided as part of the current construction works being carried out nearby. My clients accept the costs associated with this construction.

Should you require further information please contact me as identified above”

Report: (Water & Sewerage Manager – I Schiefelbein)

The owner of this property has requested a sewer connection to the sewerage scheme currently under construction at Groundwater Road, Southside.

The property is currently outside the defined sewerage area.

Once the scheme – Groundwater Road pump station is completed this property could be connected to sewerage. The estimated cost of this connection is \$23,000.00. The most cost effective design would service the adjacent property, pass through another property and provide infrastructure which could then in the future be utilised to service other properties. If these two (2) property owners contributed towards the cost, then the cost for each of them would be considerably reduced. These two property owners would also have to pay for the connection of their house drain to the sewer.

Council has not been applying infrastructure charges to connect existing residential properties to sewerage.

In the future if these properties were sewerage Council's would pay the full cost of the sewer connection. Council may also at this time construct the house connection if that is the policy at that time. The timing and extent of any sewerage scheme in this area is unknown and subject to Council determination.

Recommendation: (Water & Sewerage Manager – I Schiefelbein)

Recommend Council advise the Mr David Sabiston and the property owner that:

- (a) **The property at 3 Perry Lane can be connected to sewerage scheme subject to the payment of \$23,000 (excluding gst) for the sewer connection.**
- (b) **If the other affected owners agree the cost of the sewer could be shared.**
- (c) **Subject to the payment above Council include the property in the defined sewer area and construct the sewer.**

11/7	DA11126 – Koumala Road Pump Station, Lot 1 RP73188, Koumala Road Southside
------	--

Re: DA11126 – Koumala Road Pump Station, Lot 1 RP73188, Koumala Road Southside
From: Water & Sewerage Manager – I Schiefelbein
File: DA11126
Date: 30 January 2008

Report: (Water & Sewerage Manager – I Schiefelbein)

A subdivision for a property at Lot 1/RP73188, Koumala road was approved in 2006. Since this time the property has been sold on two occasions. A potential new owner has requested the current cost for a sewage pump station to service the development.

In May 2006 Council determined vide Minute W12/05/06 that:

1. ***Council would provide a sewage pump station to service the pump station subject to payment of a contribution of \$60,000.00 in addition to the contribution for the pump station normal augmentation fees would apply to each allotment at the standard infrastructure charge rate.***
2. ***Provision for connection to adjacent existing lots would be required. Council would pay the additional costs for the work required subject to agreement on cost.”***

Since this time costs have increased significantly. The total estimated cost (gst exclusive) has now increased from \$170,000 to \$200,000.00. The pump station has the potential to service other areas and the contribution of \$60,000 was determined on a proportional basis. Because of the increase in cost the contribution should also increase.

Recommendation: (Water & Sewerage Manager – I Schiefelbein)

Recommend that the potential new owner and the current owner be advised that:

1. Council would provide a sewage pump station to service the subdivision subject to payment of a contribution of \$70,000.00 (gst exclusive). In addition to the contribution for the pump station augmentation fees would apply to each allotment at the standard infrastructure charge rate.
2. Provision for connection to adjacent existing lots would be required. Council would pay the additional costs for the work required subject to agreement on cost.

11/8	Construction of Sewage Treatment Plants – Cooloola Coast, Contract 2007/2008-3, Contract Administration
------	---

Re: Construction of Sewage Treatment Plants – Cooloola Coast, Contract 2007/2008-3, Contract Administration
From: Water & Sewerage Manager – I Schiefelbein
File: WS07/00035
Date 21 January 2008

Report: (Water & Sewerage Manager – I Schiefelbein)

Contract Administration for construction of the three (3) sewage treatment plants on the Cooloola Coast is being carried out by the Water and Sewerage Department.

The nominated Superintendent in the Annexure A in the Tender Documents is the Water and Sewerage Department Manager who will be required to act in accordance with Clause 23 of the General Conditions of Contract. The following paragraphs are extracts from the book on “Effective Contract Management” by Ray Valentine.

“The role of Superintendent is a demanding one that has responsibilities regarding the administration of the contract to both the Owner and the Contractor. The exercise by the Superintendent of the power conferred on him by the contract, is binding on both parties.

The function of the Superintendent as “agent” of the Owner is to ensure the timely and satisfactory completion of the works and that the Contractor is paid for the work done in accordance with the contract. The Superintendent therefore has to act primarily in the interests of the Owner as the party that

initiated the contract and has the major interest in seeing the works satisfactorily completed.

The contract requires the Superintendent to supervise, make determinations, give instructions, exercise discretions and to certify certain things, and in doing so, it is essential that the Superintendent recognise and respect the interests and entitlements of the Contractor under the contract.

The role of the Superintendent requires him to act at times as if he is an independent neutral. It is essential that the Superintendent be allowed to exercise this role without influence or restraint by the Owner's management.

The Contractor enters into the contract in the knowledge that the Superintendent is to be nominated by the Owner and that, as an employee of the Owner, he is not necessarily a completely unbiased person. The Contractor accepts that the Superintendent will be the person supervising and administering the contract and making determinations between the parties. He expects that the Superintendent will do this in a fair and professional manner.

This places a special responsibility on the Superintendent to exercise care in the administration of the contract and the making of determinations affecting the interests of both parties. It also places a special responsibility on the Owner, to allow the Superintendent the freedom to carry out his duties as defined in the contract.”

It should be noted that the contract is likely to be subject to legitimate claims for variation extras and deductions. The Superintendent should be given guidance on the extent of the authorisation to approve variations to enable to work to progress in a timely manner and not to delay the contract. A recommendation is made in this regard for Council's consideration.

Recommendation: (Water & Sewerage Manager – I Schiefelbein)

Recommend that the Superintendent (Manager of Water & Sewerage) be authorised to approve of variations to the contract as follows:

- (a) All deductions;**
- (b) Any extras, the quotation of which will not exceed 1% of the tender up to a maximum total sum of 5% of the tender.**

**SECTION 12: WATER & SEWERAGE DEPARTMENT -
GENERAL BUSINESS****SECTION 13: HEALTH & COMMUNITY SERVICES
DEPARTMENT****13/1 Pigeon Problem throughout the Shire – Minute G57/12/07 refers**

Re: Pigeon Problem throughout the Shire – Minute G57/12/07 refers
From: Health & Community Services Manager, M. Grant
File: CA97/00064 Minute W22/05/06
Date: 30 January 2008

Minute G57/12/07 from the General Meeting of Council held on 11 December 2007 resolved:

That Council request the Health & Community Services Manager to look into ways in which the number of pigeons throughout the Shire can be eliminated and table a report to Council.

Report: (Health & Community Services Department Manager – M R Grant)

Council considered this matter in 2006 for Council buildings (Town Hall, Gallery, Old Bank Building, Mary Street Council Chambers) and as a result Council's Corporate Services Department has arranged a regular control program for Council buildings via a contractor.

With respect to a Shire wide baiting control program, advice received from an authorised pest controller indicates that the baiting must be carried out in a controlled environment where pigeons frequent. In the past it has been the practice for individual property owners to arrange control programs.

Recommendation: (Health and Community Services Department Manager – M R Grant)

Recommend that the Corporate Services Department continue with it's current pigeon control program for the Town Hall, Gallery, Old Bank Building and the Mary Street Council Chambers.

13/2	Unusually Low Bird Numbers – Minute G48/01/08 refers
------	--

Re: Unusually Low Bird Numbers – Minute G48/01/08 refers
From: Health & Community Services Department Manager –
M R Grant
File: G37/0108
Date: 30 January 2008

**Report: (Health and Community Services Department Manager –
M R Grant)**

I refer to Minute G48/01/08 which states the following:

“That the Health & Community Services Manager be requested to investigate the decrease in the population of birds at the Tin Can Bay Sewerage Treatment Plant and appropriate action be taken.”

Landfill operations at the Tin Can Bay Waste Management Facilities include fly control activities performed by an authorised pest control operator. This activity has been occurring for some years now.

Council’s recycling contractor advises that the birds that normally nest around the recycling compound are present.

A further report has been provided by Council’s Mr Ian Schiefelbein regarding operations at the Tin Can Bay Sewerage Treatment Plant.

Recommendation: (Health and Community Services Department Manager – M R Grant)

Recommend that the information be received.

13/3	Petition Waste Management, Langshaw – Minute G51/01/08 refers
------	---

Re: Petition Waste Management, Langshaw – Minute G51/01/08 refers
From: Health & Community Services Department Manager – M R Grant
File: CG97/00014
Date: 30 January 2008

**Report: (Health and Community Services Department Manager –
M R Grant)**

I refer to Council **Minute G51/01/08** which states the following:

“For your attention please to report to the Works & Services Committee Meeting on 5 February 2008.”

This matter has been addressed by Council on 15 January 2008 where Council resolved the following vide Minute G12/01/08:

“That Council advise the Primary Petitioner Mrs Karen Berry pursuant to Council Minute G53/12/07 (xRef-W34/12/07) as follows:-

- 1. Properties identified on petitions will be treated as objections and that wheelie bins will not be delivered to them unless requested.*
- 2. Objections will be assessed by Council at a later date, with a decision pending.”*

Reference is made to Council Minute G85/01/08 where Council resolved the following:-

“That the Petition be not received because the matter has been dealt with previously on a number of occasions and also due to the inappropriate language contained in the Petition”.

Recommendation: (Health and Community Services Department Manager – M R Grant)

Recommend that Council advise the primary petitioner that the matter has been considered by Council and Minute G12/01/08 stands.

SECTION 14: HEALTH & COMMUNITY SERVICES DEPARTMENT - GENERAL BUSINESS
--

SECTION 15: ATTACHMENTS

Attachment 1: Record of Traffic Advisory Committee Meeting held 3/12/2007

SECTION 16: IN COMMITTEE MATTERS

RECORD

TRAFFIC ADVISORY COMMITTEE MEETING

3 DECEMBER 2007

1.0 ATTENDANCE

Cr Ian Petersen - Cooloola Shire Council
Acting Snr Sgt Ron Vann – Queensland Police Service
A/OI Snr Sgt Phil Edwards – Queensland Police Service
Sgt Peter Webster - Queensland Police Service
Luke Kidd - Department of Main Roads
Martin Leja - Department of Main Roads
Mark Polley - Bus Operators Association
Ross Chapman – Cooloola Shire Council

2.0 APOLOGIES

Apologies were tabled for Cr Donna Neilson and Cr Larry Friske of Cooloola Shire Council and Carol Raymond of Queensland Transport.

3.0 RECORD OF PREVIOUS MEETING

Record of meeting held on 3 September 2007 as distributed was agreed to be a true and accurate record of meeting.

4.0 BUSINESS ARISING FROM PREVIOUS RECORD

.01 Removal of Traffic Signals at Central School – R. Chapman

R. Buddle advised signage at school is confusing, R. Chapman to review all signage for any that should be removed. R. Chapman reported signage is being updated. Traffic counts at signals (as attached) show use is well below warrants. Agreed that to dismantle lights could be seen as wasted expenditure, so leave for now pending any complaints.

.02 Centreline Marking of Channon Street Intersection – Snr Sgt P. Edwards

Channon Street double line at intersections, Department of Main Roads asked to rectify Nash St, King St, O'Connell St, Henry St as they are all marked the same way. L. Kidd advised although centreline should be removed as requested, all district intersections have been incorrectly marked and policy is to correct as overlays/reseals are carried out. However, as a result of Police concerns of the incorrect actions of many in front of Police Station, Department of Main Roads will correct all such line marking on Gympie Connection Road.

.03 Mary Street Crossings – Cr D. Neilson

Still some confusion particularly at Smithfield Street intersections where no pedestrian crossings, could painting on crossing assist. R. Chapman reported that whilst there may be some confusion, any painting on the roadway seriously affects skid resistance and due to low risk, it is preferred to leave crossings as they are.

.04 Yabba Creek Road Accident at Crossing No. 5 – Snr Sgt P. Edwards

Constable B. Greer of Imbil Police believes warning signs are required for Give Way sign following recent accident. L. Kidd advised advance warning signs were in place for the particular accident but inspection has highlighted need for some additional guide posts and chevron markers for approach from the other direction.

.05 Children Warning Sign on Bruce Highway – Sgt P. Webster

Council letter (ref SGJMcL:nmy00303) refers. M. Leja and S. McLeod to inspect. Existing signage is acceptable.

.06 Gympie Intersection Crash Data – Snr Sgt P. Edwards & R. Chapman

R. Chapman advised that an analysis was being made of crash statistics around Gympie. P. Edwards advised Qld Police Service doing the same exercise. A meeting to be arranged in new year to discuss findings and possible solutions.

5.0 GENERAL BUSINESS

.01 Bus Stop Area One Mile School – M. Polley

Stop/interchange, re letter from One Mile SS Principal, we believe there are about 20 buses that use this area as a pickup and/or interchange morning and arvo. Problems with entering & exiting Phoenix St. and Allen

Lane are causing delays and discouraging operators from using the Phoenix Street bus stop. R. Chapman advised that some short and long term proposals have been discussed with school and M. Polley. R. Buddle asked to be given copies of proposals.

.02 Cartwright Rd – Coinda St, intersection needs widening – M. Polley

Buses turning into Coinda St don't fit when other traffic is in Coinda St or vehicles are parked near intersection in Coinda St, also buses must cross the double centre line when using the intersection at anytime. R. Chapman advised inspection will be made to ensure yellow line marking in place to match signage.

.03 Two Mile School – M. Polley

Update, any reports? M. Leja advised crash report still being prepared.

.04 Pine Street – Cartwright Road – M. Polley

Turn left ramp very difficult to access with cars & trucks parked, requires "No Standing" signs. R. Chapman to inspect and assess if appropriate.

.05 Re: Bus Parking – Calton Hill – M. Polley

We are now using the southern side of Bligh St in Hilton Road and this is working well but some concerns with how students get access to this stop, also signage is required. R. Chapman to inspect and assess if appropriate with Police.

.06 Goomboorian Store Bus Stop- M. Polley

Difficult to access when coming from Gympie, buses block road as they are required to move to the left onto the gravel to turn to stop. Refer to Department of Main Roads for review.

.07 "Give Way" sign Cnr Bruce Hwy and Pinewood Ave – M. Polley

Needs to be moved 1.5m back up Pinewood Avenue. Department of Main Roads to arrange as requested.

.08 Bruce Highway Gympie – D. Neilson

Signage and line marking to be reviewed for Cross St and Rose St intersections as cars accessing highway from these streets heading south are currently using left north bound lane instead of entering south bound lanes therefore driving into oncoming traffic. Refer to Department of Main Roads and Cooloola Shire to inspect.

09 Hooning – D. Neilson

Hooning occurring Watson Road and Sorensen Road. Police advised taking action all over area with three (3) cars impounded over the weekend.

.10 Bruce Highway at Matilda – P. Webster

Pavement failures outside Matilda need attention. Department of Main Roads reported overlay project about to commence.

.11 Bus Route Planning – R. Chapman

R. Chapman asked that bus routes be planned in full consultation with Council as some new routes were travelling on streets not built for buses. R. Buddle referred R. Chapman to Cathy Kennedy.

.12 Speeding Red Hill Road – R. Chapman

Minute G48/11/07 speeding problems being encountered by residents. Meeting agreed that little can be done in this area to prevent hooning other than policing.

.13 Wide Bay Highway / Bruce Highway Intersection – Sgt P. Webster

Tourist sign in centre median blocks visibility for right turning vehicle out of Wide Bay Highway. Department of Main Roads to inspect.

.14 Victory Store Parking & Access Issues – Sgt P. Webster

General congestion in this area is continuing to worsen. Refer to Department of Main Roads and R. Chapman to review if some simple measures can be taken.

6.0 SPEED MANAGEMENT COMMITTEE

.01 Speed Limit Bayside Road & Investigator Ave, Cooloola Cove – R. Chapman

Request to reduce the speed limit on Bayside Road between 42 Bayside Road to 22 Queen Elizabeth Drive from 80 km/h to 60 or 70 km/hr, due to this being a residential area. R. Chapman reported review conducted in conjunction with L. Kidd recommended both roads be made 60 km/hr. Agreed.

.02 Speed Limit on Waddell Road, Gympie – R. Chapman

Request to reduce the speed limit on Waddell Road near the industrial area from 80 km/hr. R. Chapman reported speed review has been conducted except for Q Limits. Agreed that subject to Q Limits results speed zones be reduced from 80 km/hr to those as determined.

.03 Speed Camera Sites – P. Webster

A review of potential speed camera sites as identified through accident history was undertaken as follows:-

- Kenilworth Brooloo Road (declared road) - Agreed with police recommendation that no suitable site is available.
- Tin Can Bay Road (declared road) in vicinity of Toolara - Agreed with police recommendation that a suitable site exists near Cooloola Coast Road.
- Gympie Brooloo Road (declared road) vicinity of Riversdale Road - Agreed with police recommendation that several sites exist in this area.

7.0 CLOSE – NEXT MEETING

The next Traffic Advisory Committee Meeting is proposed for **1:00 pm Monday 3 March 2008.**

**Pedestrian & Vehicle Count at Pedestrian Crossing
O'Connell St, Gympie
Thur 22/02/2007 8:30am - 9:00am & 2:45pm - 3:15pm**

	Time	No. of Vehicles	No. of Pedestrians
AM	8:30 - 8:45	50	9
	8:45 - 9:00	64	9
	TOTAL 1/2 hr AM	114	18
PM	2:45 - 3:00	48	2
	3:00 - 3:15	77	11
	TOTAL 1/2 hr PM	125	13

**Pedestrian & Vehicle Count at Pedestrian Crossing
O'Connell St, Gympie
Thur 29/11/2007 8:30am - 9:00am & 2:45pm - 3:15pm**

	Time	No. of Vehicles	No. of Pedestrians
AM	8:30 - 8:45	54	0
	8:45 - 9:00	55	0
	TOTAL 1/2 hr AM	109	0
PM	2:45 - 3:00	38	0
	3:00 - 3:15	52	7
	TOTAL 1/2 hr PM	90	7